



Installation Guide

USB VGA KVM Console Extender

GCE500U

PART NO. M1125-a

Table of Contents

Package Contents	4
System Requirements	5
Overview	6
Rack Mounting	9
Grounding	11
Standard Installation	12
Advanced Installation	16
Operating Modes	20
LED Indications	21
Federal Communications Commission (FCC) Statement	22
CE Statement	23
SJ/T 11364-2006	24
Limited Warranty	25
Contact	26

Package Contents

- 1 x GCE500U Local Unit
- 1 x GCE500U Remote Unit
- 1 x USB KVM Cable
- 2 x Rack Mount Kit
- 2 x Grounding Cable
- 2 x Power Adapter
- 1 x Installation Guide
- 1 x Warranty Card

System Requirements

- A Solid CAT5e/6 Cable

Console

- VGA, SVGA, SXGA, UXGA, WUXGA or Multisync monitor
- USB Keyboard and mouse

Computer

- VGA, SVGA, SXGA, UXGA, WUXGA or Multisync video output
- An available USB port

Overview

Front View

1. CPU Port
2. Remote LED
3. Local LED
4. Operating Mode Pushbutton
5. Link LED
6. Remote LED

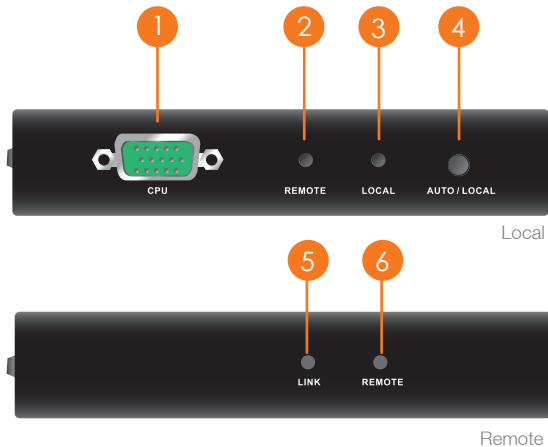

Rear View

1. Power Jack
2. USB Mouse Port
3. USB Keyboard Port
4. Extension Input/Output Port
5. VGA Monitor Port

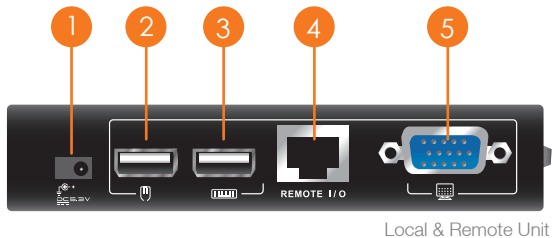

Side View

1. Grounding Terminal

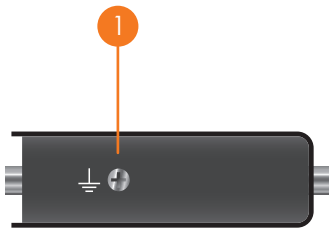

Local & Remote Unit

Rack Mounting

Step 1

Unscrew the screws that are in the bottom of the housing, then screw the provided mounting bracket on top of the units with the screws.

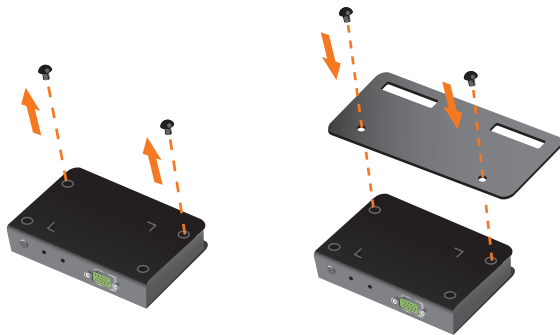

Step 2

Screw the other side of the bracket onto any available area on the rack.

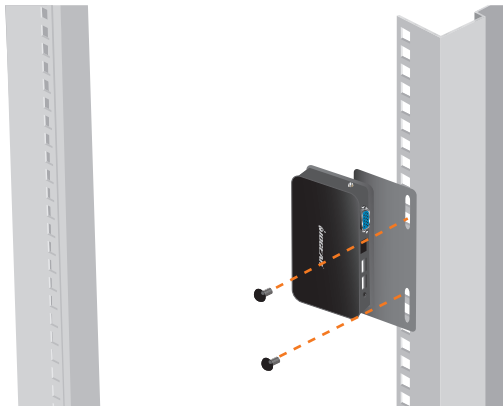

Grounding

To prevent damage to your installation, it is important that your devices are properly grounded. Use the provided grounding wires to ground the Local and Remote Unit of the GCE500U. Connect one end of the wire to the grounding terminal and the other end of the wire to a suitable grounded object.

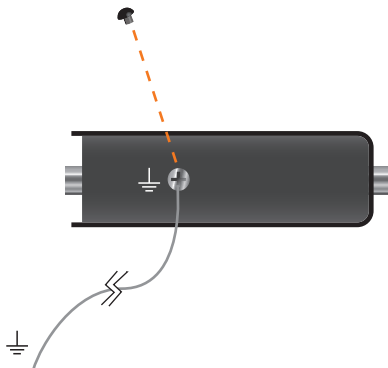

Standard Installation

Note: Please make sure your computer is completely shutdown before you begin.

Step 1

Connect the power adapter between the wall outlet and the unit (Both local and remote units)

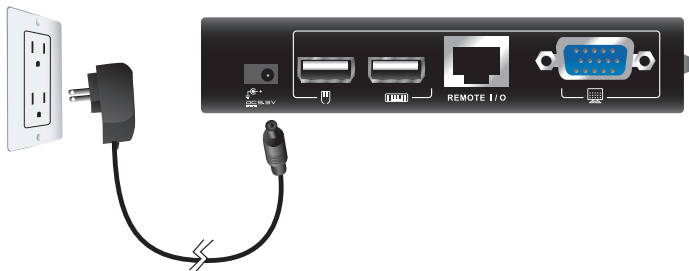

Step 2

Connect the provided USB KVM Cable between the local unit's CPU port and the computer

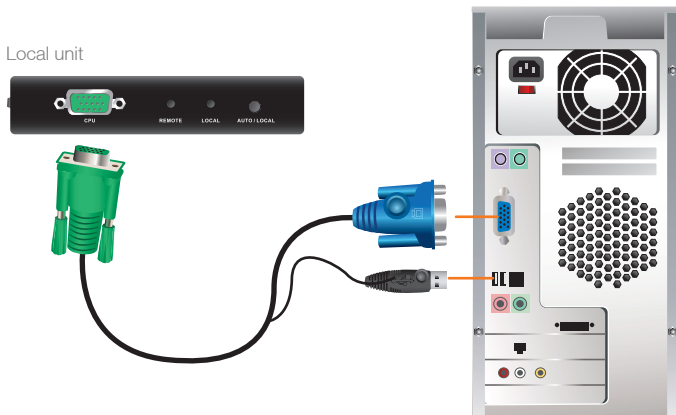

Step 3

Connect your VGA monitor to the console VGA port, USB keyboard and mouse to the Console USB keyboard and mouse port respectively (Both local and remote units)

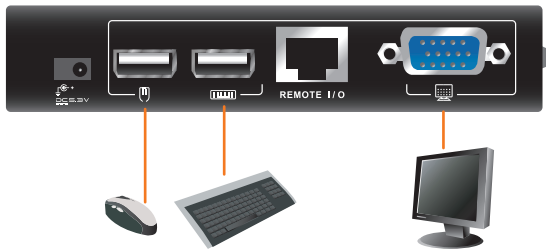

Step 4

Connect your CAT5e/6 Cable between the Extension Input/Output Ports from the local and remote unit.

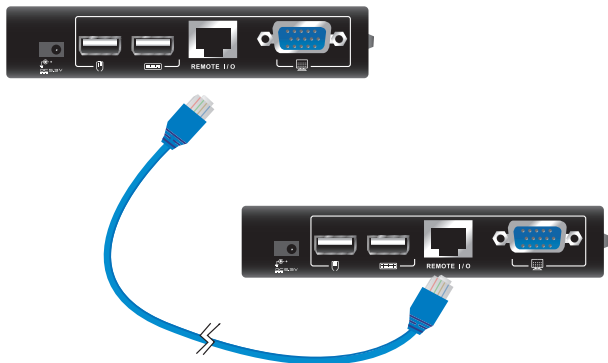

Final Step

Turn on your computer and monitors.

Advanced Installation

Note: Please make sure your computers are completely shutdown before you begin.

Step 1

Connect the power adapter between the wall outlet and the unit (Both local and remote units).

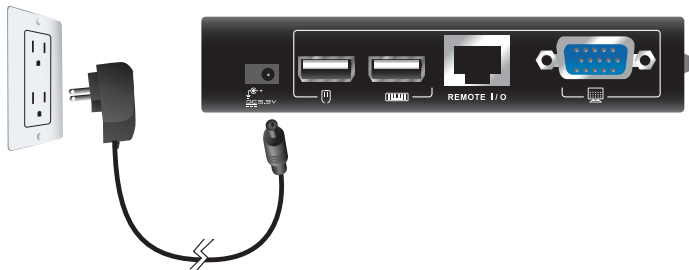

Step 2

Connect the provided USB KVM Cable between the local unit's CPU port and the console VGA and keyboard port of the KVM.

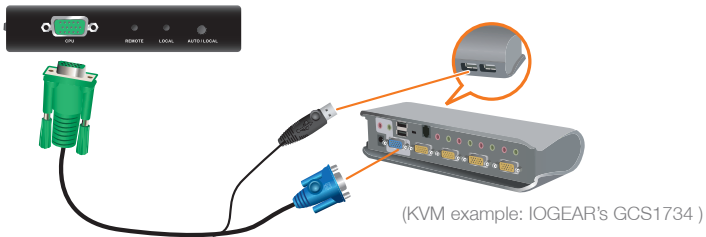

Step 3

Please refer to the user manual of the specific KVM to complete the KVM installation.

Note: Please ignore the Console VGA, USB Keyboard and mouse ports installation steps from the KVM's user manual because you have done this portion from the last step (Step 2).

Step 4

Connect your VGA monitor to the console VGA port, USB keyboard and mouse to the Console USB keyboard and mouse port respectively (Both local and remote units).

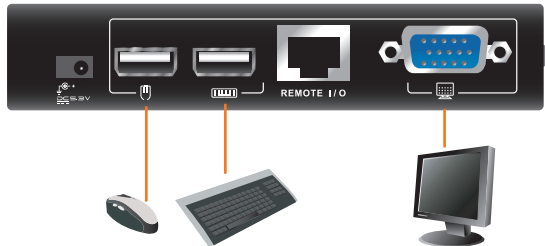

Step 5

Connect your CAT5e/6 Cable between the Extension Input/Output Ports from the local and remote unit.

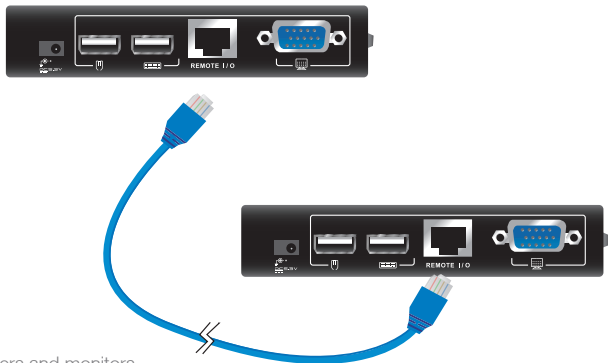

Final Step

Turn on your computers and monitors.

Operating Modes

Mode	Description
Local	Only local console has access
Remote	Only remote console has access

Note: Remote Mode cannot be selected by the Operating Mode Pushbutton, it only occurs when Auto Mode grants the access to the remote console.

Auto (Default)	Either local or remote console can have access, but only one console can have access at a time. Whichever console is being used first will be granted with the access, for example, if local unit is being used first, then it will turn into local mode, but when the local unit becomes idle, it will turn back into Auto Mode
----------------	--

LED Indications

LED Status	Description
Local LED ON Remote LED OFF	Local Mode
Local LED OFF Remote LED ON	Remote Mode
Both Local and Remote LED flash	Auto Mode
Link LED ON	Extension connection is established
Link LED flashes	Extension connection is not established

Federal Communications Commission (FCC) Statement

This equipment has been tested and found to comply with the limits for a Class B digital device, pursuant to Part 15 of the FCC Rules. These limits are designed to provide reasonable protection against harmful interference in a residential setting. This product generates, uses, and can radiate radio frequency energy and, if not installed and used as directed, it may cause harmful interference to radio communications. Although this product complies with the limits for a Class B digital device, there is no guarantee that interference will not occur in a particular installation.

CE Statement

This device has been tested and found to comply with the requirements set up in the council directive on the approximation of the law of member states relating to EMC Directive 89/336/EEC, Low Voltage Directive 73/23/EEC and R&TTE Directive 99/5/EC.

The product has been approved for LVD and covered the following countries:
Belgium, Denmark, France, Germany, Italy, Portugal, U.K., Spain, Sweden

SJ/T 11364-2006

部件名称	有毒有害物质或元素					
	铅 (Pb)	汞 (Hg)	镉 (Cd)	六价 (Cr(VI))	多溴联苯 (PBB)	多溴二苯醚 (PBDE)
电器部件	●	○	○	○	○	○
机构部件	○	○	○	○	○	○

○:表示该有毒有害物质在该部件所有均质材料中的含量均在SJ/T 11363-2006规定的限量要求之下。

●:表示符合欧盟的豁免条款，但该有毒有害物质至少在该部件的某一均质材料中的含量超出SJ/T 11363-2006的限量要求。

x: 表示该有毒有害物质至少在该部件的某一均质材料中的含量超出SJ/T 11363-2006的限量要求。



Limited Warranty

IN NO EVENT SHALL THE DIRECT VENDOR'S LIABILITY FOR DIRECT, INDIRECT, SPECIAL, INCIDENTAL OR CONSEQUENTIAL DAMAGES RESULTING FROM THE USE OF THE PRODUCT, DISK, OR ITS DOCUMENTATION EXCEED THE PRICE PAID FOR THE PRODUCT.

The direct vendor makes no warranty or representation, expressed, implied, or statutory with respect to the contents or use of this documentation, and especially disclaims its quality, performance, merchantability, or fitness for any particular purpose. The direct vendor also reserves the right to revise or update the device or documentation without obligation to notify any individual or entity of such revisions, or updates. For further inquiries please contact IOGEAR.

Contact

IOGEAR

19641 Da Vinci

Foothill Ranch, CA 92610

P 949.453.8782

F 949.453.8785

Visit us at: www.iogear.com





About Us



FUN

IOGEAR offers connectivity solutions that are innovative, fun, and stylish, helping people enjoy daily life using our high technology products.



GREEN

IOGEAR is an environmentally conscious company that emphasizes the importance of conserving natural resources. The use of our technology solutions helps reduce electronic waste.