

## GCL1808KITP

## 8-Port LCD Combo KVM Switch with PS/2 KVM Cables



IOGEAR's GCL1808KITP is an integrated LCD console and 8 port KVM (keyboard, video, and mouse) switch with bundled PS/2 KVM cables that offers secure access to 8 VGA, PS/2 computers. It features a convenient rack mountable sliding / retractable 17" TFT LCD active matrix monitor and keyboard with built-in touchpad for a space-saving and streamlined integration. For added convenience it also supports an external USB mouse. An extra USB / PS/2 console port is provided on the rear panel to manage the LCD KVM switch from an external console (monitor, keyboard, and mouse). All this in a universal 1U rack mount space.

The GCL1808KITP supports both PS/2 and USB keyboards and mice for the connected computers, and the GCL1808KITP supports USB\*\* peripheral devices to be used for system upgrades with the attached computers. A single GCL1808KITP can control up to 8 computers. As many as 8 additional compatible KVM switches can be cascaded to reach up to 128 computers\* controlled from a single keyboard, monitor, and mouse console with easy computer switching via front LED pushbuttons, OSD, and Hotkeys.

- Integrated 8-port KVM console featuring a 17" TFT LCD active matrix monitor, keyboard and touchpad
- 1280 x 1024 resolution on 17" rack mount LCD provides a sharp video display
- Equipped with 8 PS/2 KVM Cables
- Adjustable depth to fit different sizes of racks
- Auto Scan Mode to monitor connected computers
- Broadcast Mode to send commands to all connected computers
- Multi platform OS support - Windows®, Mac, Sun Solaris™, and Linux®
- Easy to operate - computer selection via front panel pushbutton LED's, intuitive OSD (on screen display), and hotkeys
- External USB mouse port for convenience
- External USB or PS/2 with VGA Console port
- USB media port support for attached USB computers (system upgrades, etc)\*\*
- Cascade up to 2 levels - control up to 128 computers from a single console\*
- Security - 2 level password protection for OSD
- DDC Emulation - Video settings of each computer are automatically adjusted for optimal output to the monitor
- Rack mountable in a 19" (1U) system rack
- Custom ASIC provides an auto-sensing function that recognizes the position of each station on the installation
- Fully Supports DDC2B
- Firmware Upgradable

\*Cascade with IOGEAR 8/16-Port VGA Combo KVM Switch (Model No. GCS1808 and GCS1716)

\*\*Only systems connected with the USB KVM cables will be able to access the front USB port for system upgrades and shared peripherals



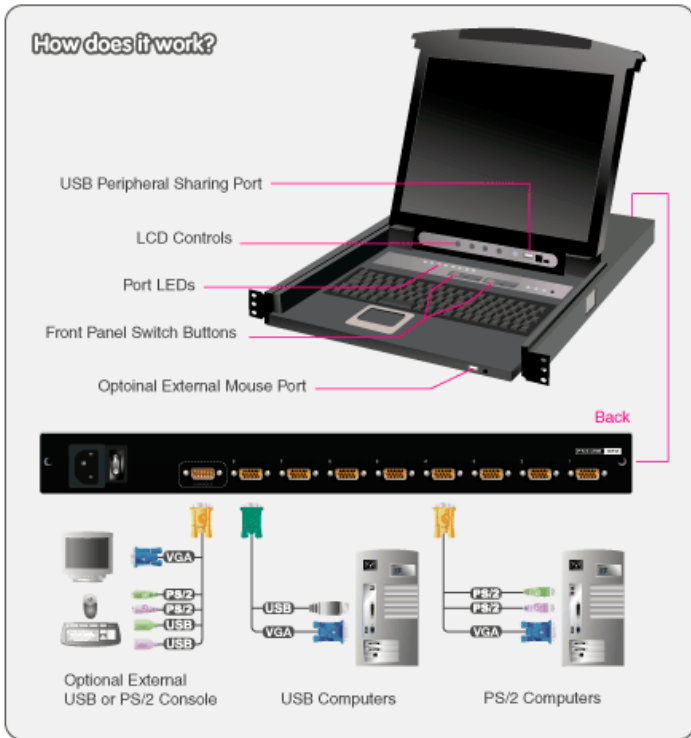

**Requirements**

**Computers:**

- VGA, SVGA, or MultiSync video graphics card with an HDB-15 port
- PS/2 mouse and keyboard ports (6-pin mini DIN) or 1 USB port

**Package Contents**

- 1 x 8-Port LCD Combo KVM Switch
- 4 x PS/2 KVM Cable (6ft - G2L5202P)
- 4 x PS/2 KVM Cable (10ft - G2L5203P)
- 1 x USB KVM Cable (6ft - G2L5202U)
- 1 x Console Cable
- 1 x Cascade Cable
- 1 x Firmware Upgrade Cable
- 1 x Grounding Wire
- 1 x Power Cord
- 1 x Installation Guide
- 1 x Warranty Card

## Specifications

Function	GCL1808KITP
<b>Computer Connections</b>	
Direct	8
Daisy Chain or Cascading	128
<b>Port Selection</b>	
OSD, Hotkeys, Pushbuttons	
<b>Connectors</b>	
Console	1 x SPHD-18 Male
Power	1 x 3-Prong AC Socket
<b>Console Connectors</b>	
Monitor	1 x HDB-15 Female
Keyboard	PS/2 or USB
Mouse	PS/2 or USB
Extra Mouse	1 x USB Type A Female
Flash ROM Upgrade	1 x RJ-11 Female
<b>CPU Connectors</b>	
Keyboard, Mouse, and Monitor	8 x SPHD-15 Female
<b>Switches</b>	
Reset	1 x Semi-recessed Pushbutton
Power	1 x Rocker Switch
F/W Upgrade	1 x Switch
LCD Adjustment	4 x Pushbutton
LCD Power	1 x LED Pushbutton (Orange)
Port Selection	4 x Pushbutton
<b>LEDs</b>	
On Line	8 (Orange)
Port ID	4 x 7 Segment LED Display (Yellow)
Power On	Dark Green
<b>Emulation</b>	
Keyboard	PS/2, USB
Mouse	PS/2, USB
<b>Video Resolution</b>	
1280 x 1024 @ 75Hz; DDC2B	
<b>Scan Interval</b>	
1-255 Seconds	
<b>Power Input Rating</b>	
Per AC Power Inlet, 50/60Hz	100~240VAC, 50/60Hz, 1A
<b>Power Consumption</b>	
120V, 28W	
<b>Environment</b>	
Operation Temperature	0~40°C
Storage Temperature	-20~60°C
Humidity	0~80% RH; Non-condensing
<b>Housing</b>	
Case	Metal and Plastic

Dimensions	GCL1808KITP
<b>Unit Dimensions</b>	
Width	19in.
Height	1.75in.
Depth	25in.
<b>Unit Package Dimensions</b>	
Width	30.25in.
Height	6.5in.
Depth	37.25in.
<b>Weight</b>	
Unit Pack Wt.	51.63lb
Unit Wt. w/accessories	36.67lb
Unit Wt.	27.78lb