

## GCS1802MDPKIT

# 2-Port VGA and Mini DisplayPort KVM Switch with Audio and OSD



- Switch between two computers with the push of a button
- Offers the flexibility to mix and match computer connections: VGA and DisplayPort
- Includes 2 x DisplayPort to VGA adapters
- Switching via pushbutton, hotkey, or OSD
- Save Cabling Costs: ALL cables are included

## 2-Port VGA / Mini DisplayPort KVM Switch

- Switch between two computers with the push of a button
  - Offers the flexibility to mix and match computer connections: VGA and Mini DisplayPort
  - Includes 2 x Mini DisplayPort to VGA adapters
  - Switching via pushbutton, hotkey, or OSD
  - Cost effective, Plug-N-Play solution
- Switch between two computers with the push of a button
  - Offers the flexibility to mix and match computer connections: VGA and Mini DisplayPort
  - Includes 2 x Mini DisplayPort to VGA adapters
  - Switching via pushbutton, hotkey, or OSD
  - Cost effective, Plug-N-Play solution
  - 2-port KVM switch with OSD and built-in 2-port High Speed USB 2.0 hub
  - Dual interface - Supports computers with PS/2 or USB keyboard and mouse configurations\*\*
  - Audio enabled - Full bass response provides 2.1 stereo sound
  - Console audio ports on front panel for easy access
  - Independent (Asynchronous) Hotkey switching between KVM focus, USB peripherals, and audio ports
  - Three convenient computer switching methods - front panel pushbutton, On Screen Display (OSD), or Hotkeys
  - Maximum VGA video resolution 2048 x 1536 - supports widescreen monitors
  - IOGEAR's DynaSync reads and remembers the monitor's parameters (EDID) so the user doesn't experience delays or change in video resolution when switching between or booting computers\*
  - Console mouse port emulation bypass feature supports programmable mice
  - Complete keyboard emulation for error free booting
  - Sun/Mac keyboard support and emulation\*\*\*
  - Complete solution – All cables included
  - Converts your Mini DisplayPort to VGA
    - Connect to a VGA projector, TV or monitor.
    - Works with Apple® iMac® or MacBook®
    - Compliant with Mini DisplayPort Specification 1.1a for both 1.62 Gbps and 2.7 Gbps
    - Support full Mini DisplayPort link tracking
    - Supported resolutions:
      - Full HD 1080p
      - 1920x1200
      - VGA, SVGA, XGA, SXGA and UXGA at 162 MHz pixel rate
    - Support interrupt request output for expansion function
    - Support Deep Sleep Mode (suspend mode)

\*IOGEAR's DynaSync provides the EDID support for Windows 7

\*\*PS/2 KVM Cables are available and sold separately.

\*\*\* PC keyboard combinations emulate Sun/Mac keyboards and Sun keyboards only work with Sun computers



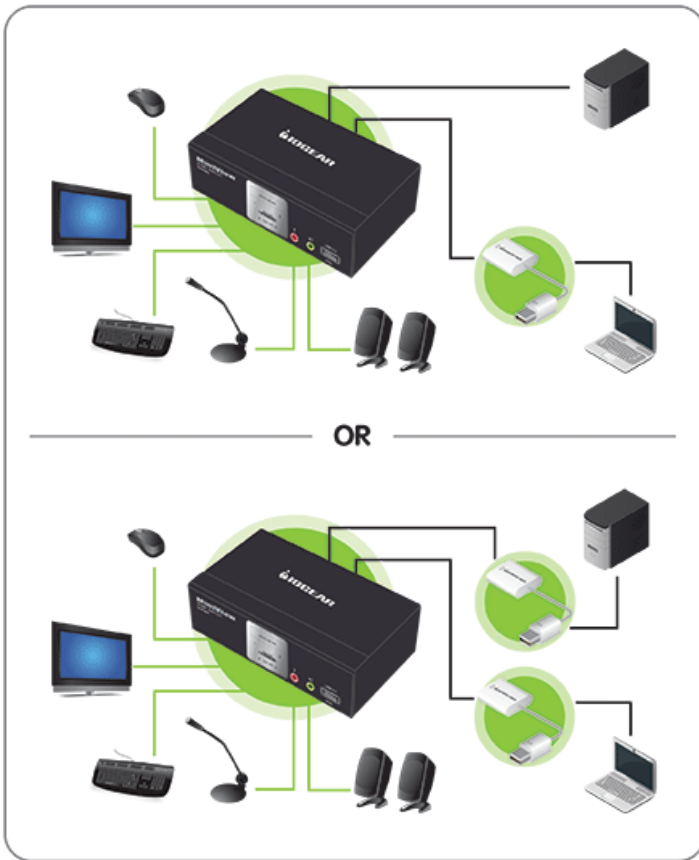

#### Requirements

#### Package Contents

- **Console:**
- Monitor with VGA capabilities
- Standard 104 key wired USB keyboard
- Standard 2 or 3 button wired USB mouse
- 
- **Computers:**
- VGA or Mini DisplayPort port
- USB or PS/2 connections
- 
- **Operating Systems:**
- Windows Vista®, Windows® 7, Windows® 8.1, Windows® 10
- Mac OS 9 to 10.x
- Oracle® Solaris
- Linux®, Unix and other USB supported systems\*\*
- 
- **Optional:**
- Computers with sound support
- 2.0 or 2.1 powered PC speakers
- Microphone

- 1 x 2-Port USB KVM Switch
- 2 x Mini DisplayPort to VGA Adapters
- 2 x Custom USB KVM Cable
- 1 x PS/2 to USB Adapter
- 1 x Firmware Upgrade Cable
- 1 x Power Adapter
- 1 x Installation Guide
- 1 x Warranty Card

\*IOGEAR's Display Emulation Technology provides the EDID support for Windows 7

\*\*Additional drivers and support may be needed

## Specifications

| Function                    | GCS1802MDPKIT                                 | Dimensions                     | GCS1802MDPKIT    |
|-----------------------------|---|--------------------------------|------------------|
| <b>Computer Connections</b> |   | <b>Unit Dimensions</b>         |                  |
| Direct                      | 2   | Height                         | 1.6" (4.1cm)     |
| <b>CPU Connectors</b>       |   | Depth                          | 2.9" (7.4cm)     |
| Monitor                     | 2 x VGA; 2 x Mini DisplayPort (with adapters) | Length                         | 5.0" (12.7cm)    |
| Keyboard                    | USB or PS/2                                   | <b>Unit Package Dimensions</b> |                  |
| Mouse                       | USB or PS/2                                   | Width                          | 10.6" (26.9cm)   |
| Microphone                  | Standard                                      | Height                         | 8.9" (22.6cm)    |
| Audio                       | 2.1   | Depth                          | 4.0" (10.2cm)    |
| Peripherals                 | 2 x USB 2.0                                   | <b>Master Carton</b>           |                  |
| <b>Console Connectors</b>   |   | Width                          | 18.2" (46.2cm)   |
| Monitor                     | VGA   | Height                         | 11.3" (28.7cm)   |
| Keyboard                    | USB   | Depth                          | 12.8" (32.5cm)   |
| Mouse                       | USB   | Master Carton Qty.             | 6                |
| Microphone                  | Standard                                      | <b>Weight</b>                  |                  |
| Audio                       | 2.1   | Master Carton Wt.              | 23.6lb (10.73kg) |
| <b>Video Resolution</b>     |   | Unit Pack Wt.                  | 3.7lb (1.68kg)   |
| <b>Cable Length</b>         |   | Unit Wt. w/accessories         | 1.1lb (0.5kg)    |
| <b>Cable Connections</b>    |   | Unit Wt.                       | 1.0lb (.45kg)    |
| Input                       | USB   |                                |                  |
| Output                      | USB or PS/2                                   |                                |                  |
| <b>LEDs</b>                 |   |                                |                  |
| USB Peripherals             | Green   |                                |                  |
| Port ID                     | Orange  |                                |                  |