

GCS1932M

2-Port 4K DisplayPort KVMP Switch with Dual Video Out and RS-232 (TAA Compliant)



- Turn a single video output to two monitors
- Up to Cinema 4K for one monitor or 4K UHD for two monitors
- Switch between 2 DisplayPort computers easily
- RS-232 Command Control
- Full cable set included for out-of-the-box setup

2-Port 4K DisplayPort KVMP Switch with Dual Monitor Output

Extend One Video Output to Two Monitors

Need to add a 2nd monitor to create a full production work environment? The IOGEAR 2-Port 4K DisplayPort KVMP Switch with Dual Video Out is the perfect solution. Turn your single (1) monitor input to two (2) monitor outputs by connecting both a DisplayPort and HDMI monitor. The built-in Multi Stream Transport (MST) hub enables two- (2) monitor outputs while using only one (1) video input from your computer. Increase your monitor real estate without modifying computer components or adding to your DisplayPort output graphics cards. MST technology for multiple monitor setups is widely used in 4K software diagnostic and other settings where viewing and monitoring details clearly is required.

- Control and switch 2 computers with 1 keyboard, mouse, and monitor(s)
- Expand 1 DisplayPort input to 2 video outputs (DisplayPort/HDMI)
- With DisplayPort 1.1 Graphic Cards:
 - Dual 4K UHD (DisplayPort/HDMI) - mirrored screen only
- With DisplayPort 1.2 Graphic Cards:
 - 1 Monitor: Up to 5K Resolution
 - 2 Monitors: Up to 4K UHD (DisplayPort/HDMI)
 - 3 Monitors: Shared video bandwidth¹
- Convenient computer selection via front panel push-buttons, hotkeys, mouse², and RS-232 commands³
- 2-Port built-in USB 3.1 Gen 1 Hub for peripheral sharing with SuperSpeed 5 Gbps data transfer
- Independent switching of KVM, USB Peripherals, and 2.1 analog audio
- Supports Ultra Wide Monitors
- DisplayPort 1.2 and HDCP compliant
- DP++ (Dual-Mode DisplayPort) technology supports HDMI and DVI adapters⁴
- Support 7.1 HD audio through DisplayPort connection⁵
- Power on Detection - GCS1932M automatically switches to the next powered-on computer
- Hot pluggable - Add or remove computers without powering down the connection
- Mouse emulation supports most mouse drivers and multifunction mice
- Mac® keyboard support and emulation⁶
- Multilingual keyboard mapping supports English, French, and German keyboards
- Firmware upgradable
- All KVM and audio cables are included

Note:

¹ 3 Monitors setup example: Monitor #1 up to 3840 x 2160, Monitor #2 up to 2560 x 1600, Monitor #3 Up to 1920 x 1200

² Supported alongside mouse emulation mode using a USB 3-button mouse wheel

³ DB9 to RJ-11 cable not included

⁴ Dual-Mode DisplayPort (DP++) requires active HDMI and DVI adapters for most display setups

⁵ HD audio through DisplayPort cannot be switched independently

⁶ PC keyboard combinations emulate Mac® keyboards.



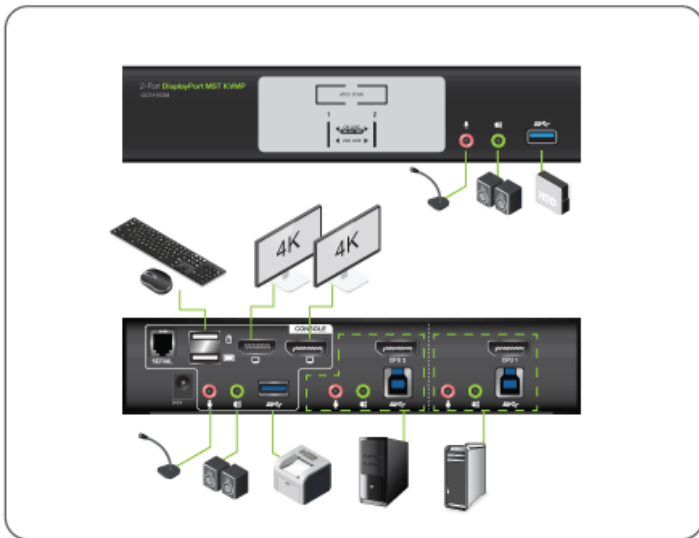

Requirements

Package Contents

- | | |
|--|---|
| <ul style="list-style-type: none"> • Console • DisplayPort or HDMI compatible monitor • Standard 104 key wired USB keyboard • Standard 2 or 3 button wired USB mouse • Microphone and speakers (optional) • • Computers • DisplayPort port • Type-A USB port • Audio ports (optional) • • Operating System • Windows® 7, Windows® 8.1, Windows® 10 • Mac OS® X 10.7 + | <ul style="list-style-type: none"> • 1 x GCS1932M 4K KVMP Dual Video Out Switch • 2 x DisplayPort Cables • 2 x USB 3.0 Cables • 2 x Audio Cable Sets • 1 x Power Adapter • 1 x Manual • 1 x Warranty |
|--|---|

*Use with video adapter may change performance

Specifications

Function	GCS1932M
Computer Connections	
Direct	2
Port Selection	
	Pushbuttons, Hotkey, Mouse (mouse port switching only works with 3-key USB mouse wheel in emulation mode), RS-232 Commands
Console Connectors	
Monitor	1 x DisplayPort (Black); 1 x HDMI (Black)
Keyboard	1 x USB Type A (Black)
Mouse	1 x USB Type A (Black)
Audio	2 x 3.5mm Mini Stereo Jack (Green; Front and Rear)
Microphone	2 x 3.5mm Mini Stereo Jack (Pink; Front and Rear)
CPU Connectors	
Monitor	2 x DisplayPort (Black)
Keyboard & Mouse	2 x USB 3.0 Type B (Blue)
Audio	2 x 3.5mm Mini Stereo Jack (Green)
Microphone	2 x 3.5mm Mini Stereo Jack (Pink)
Switches	
F/W Upgrade	1 x USB Type B
Port Selection	2 x Pushbutton
Connectors	
USB	2 x USB 3.0 Type A (Blue; Front and Rear)
Serial	1 x RJ-11 Female
LEDs	
On Line	2 x Orange
Selected	2 x Orange
Audio	2 x Orange
USB Peripherals	2 x Green
Emulation	
Keyboard	USB
Mouse	USB
Video Resolution	up to 4096 x 2160 @60 Hz (4K DCI)
Scan Interval	1-99 seconds (5 seconds default)
Power Consumption	DC 5V
Environment	
Operation Temperature	0-50 C
Storage Temperature	-20-60 C
Humidity	0-80% RH, Non-condensing
Housing	
Case	Metal

Dimensions	GCS1932M
Unit Dimensions	
Height	2.94" (7.47cm)
Length	7.875" (20cm)
Depth	1.69" (4.29cm)
Unit Package Dimensions	
Height	6.81" (17.3cm)
Width	11.25" (28.58cm)
Depth	4" (10.16cm)
Master Carton	
Height	14.75" (37.47cm)
Width	12.5" (31.75cm)
Depth	12" (30.48cm)
Master Carton Qty.	6
Weight	
Master Carton Wt.	24.7lb (11.24kg)
Unit Pack Wt.	3.68lb (1.67kg)
Unit Wt.	1.45lb (0.66kg)