

GIC320U

## 2-Port SuperSpeed USB 3.0 PCI-Express Card



Would you like to take advantage of all the new cool features SuperSpeed USB 3.0 has to offer?

SuperSpeed USB 3.0 is 10 times faster than USB 2.0, it is bi-directional (read & write data at the same time), more power efficient and is backward compatible with USB 1.1 and 2.0 devices.

IOGEAR has made it simple to add two SuperSpeed USB 3.0 ports to your existing PC, without changing the motherboard or buying a brand new computer. This card is capable of supporting SuperSpeed USB 3.0 (5Gbps). This increased bandwidth means faster upload of photos or MP3s and drastically better performance of storage devices such as external hard drives. USB 3.0 is also full-duplex, it can upload and download simultaneously (bi-directional), USB 2.0 was half-duplex. USB 3.0 also has new power-management capabilities that allow for unused devices to enter idle, suspend and sleep modes. This new efficient use of energy cuts down on your power consumption. You can also charge your USB devices faster using USB 3.0.

- Ten times faster than the current USB 2.0 specification
- Supports data transfer rate up to 5Gbps (SuperSpeed)
- LED indicator for USB port status
- Dual profile allows use in low profile & standard cases
- Backward compatible with current USB 2.0 and USB 1.1 devices
- Each USB port supplies maximum 5V/900mA power output
- Compliant with USB 3.0 specification Revision 1.0
- Support PCI Express Base Specification Revision 2.0



### How does it work?

- Install the card in available PCI-Express slot, adding two USB 3.0 SuperSpeed Ports
- Connect USB devices such as printer, external hard drive, camcorder to the USB 3.0 ports for transfer speed up to 5Gbps

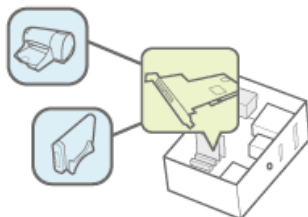

### Requirements

- Windows XP®, Windows Vista®, and Windows 7®
- Available PCI Express slot

Note: USB 3.0 SuperSpeed is only attainable when one USB 3.0 device is connected to another USB 3.0 device.

### Package Contents

- 2-Port USB 3.0 PCI Express Card
- Low Profile Bracket
- Installation CD
- Quick Start Guide
- Warranty / Registration Card

## Specifications

Function	GIC320U
<b>USB Specification</b>	USB 3.0
<b>Ports</b>	2 ports
<b>Data Rate</b>	Supports data transfer rate of Low-speed(1.5Mbps) / Full-speed(12MBps) / High-speed(480MBps) / Super-speed(5Gbps)
<b>Computer Interface</b>	PCI Express
<b>Connectors (Console)</b>	2 x USB 3.0 Type A (F)
<b>Operating System Support</b>	Windows XP, Windows Vista (32/64-Bit), Windows 7 (32/64-Bit)
<b>Operating Temperature</b>	32°F ~ 134.6°F (0°C ~ 57°C)
<b>Storage Temperature</b>	-4°F ~ 185°F (-20°C ~ 85°C)
<b>Power Connections</b>	ATX 4 pin power connector

Dimensions	GIC320U
<b>POP Information</b>	
10" Peg Hook	4
6" Peg Hook	2
<b>Unit Dimensions</b>	
Width	3.5"
Height	4.75"
Depth	0.75"
<b>Unit Package Dimensions</b>	
Width	6"
Height	8.75"
Depth	2.25"
<b>Master Carton</b>	
Width	8"
Height	7"
Depth	15"
Master Carton Qty.	6
<b>Weight</b>	
Master Carton Wt.	4.7 lb
Unit Pack Wt.	0.65 lb
Unit Wt.	0.15 lb