

GPSU21W6

USB 2.0 Print Server, 1-Port Multi-Language Version



IOGEAR's palm sized 1-port USB 2.0 Print Server allows any networked computer to share a USB printer. It complies with USB 2.0 specifications (backward compatible with USB 1.1 spec.), and provides users with an auto-sensing Ethernet port that works with either 10Base-T or 100Base-T networks. This unit also supports multiple protocols and multiple operating systems, and it integrates Internet Printing Protocol (IPP) in this print server to allow users to print from any computer over a LAN/WAN or the Internet by specifying the device's URL.

The built-in web management feature provides more convenience by allowing the user to configure, monitor and even reset the print server via a web browser. This eliminates the need to place the printer right next to the computer. Print jobs can be sent to a printer in another country just as easily as to a printer in the same office. Why bother sending a degraded fax image while you can print an original at the destination?

Device is not compatible with Multi-Functional Printers.

- Easily connect your USB printer to a network
- Allows multiple computers to share one USB printer on the network
- Print from any computer on your network or from across the Internet
- Supports DHCP Client and multiple network protocols
- 10Base-T / 100Base-T auto-sensing
- Supports Telnet and Web Management software



How does it work?

- Print from any networked computer
- Send print jobs over Internet connection
- Share one USB printer among multiple computers

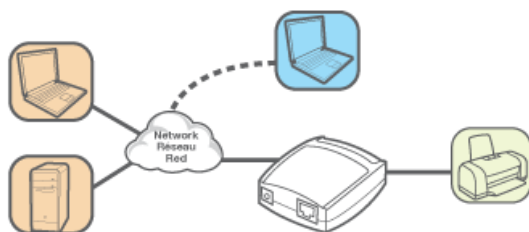
**Requirements**

- Windows® 98SE, Windows® ME, Windows® 2000, Windows® XP, Windows® Vista, Windows® 7, Windows® 8/8.1
- Mac OS 9.22 or later
- Unix/Linux
- Printer with USB connection
- DHCP server on the network

Package Contents

- 1 x 1-Port USB 2.0 Print Server
- 1 x CAT5 Patch Cable
- 1 x Power Adapter
- 1 x Installation CD
- 1 x User Manual
- 1 x Warranty / Registration Card

Specifications

Function	GPSU21W6
Cable Length	6 Feet
Network Protocol	IPX, TCP/IP, NETBUEI, APPLE TALK, lpr, smb (Over IP)
Cable Type	CAT5
Network Interface	10/100Mbps RJ45
Printer Connection	USB 2.0, USB 1.1
Standards	IEEE 802.3 10Base-T; IEEE 802.3u 100Base-T; USB 2.0
Management	Web, Telnet, PSAdmin, SNMP

Dimensions	GPSU21W6
Unit Dimensions	
Height	1 in. (2.54 cm)
Length	2.5 in. (5.72 cm)
Depth	2.4 in. (6.096 cm)
Unit Package Dimensions	
Height	5.5 in. (14cm)
Width	8 in. (20.32cm)
Depth	2.625 in. (6.6cm)
Master Carton	
Height	12.375 in. (31.41cm)
Width	8.875 in. (22.52cm)
Depth	17.5 in. (44.45cm)
Master Carton Qty.	12
Weight	
Master Carton Wt.	14.05 lb. (6.37 Kg)
Unit Pack Wt.	1.05 lb. 0.47 Kg)
Unit Wt.	0.12 lbs (0.05 Kg)