

PCI Express Cards

GIC3U2

2-Port SuperSpeed+ USB-A PCI-Express Card

2-Port SuperSpeed+ USB-A PCI-Express Card

IOGEAR's GIC3U2 2-port USB-A PCI Express card adds USB 3.1 (gen2) Type-A ports to your computer. The high performance expansion card includes a low-profile bracket and features efficient construction that fits into any x4, x8 and x16 PCIe slot. This PCIe card instantly upgrades your computer by equipping it with a lightning fast data transfer rate of 10Gbps, that's twice the speed of USB 3.0 (5Gbps) and almost 20 times that of USB 2.0 (480Mbps).

Cost Effective Backwards Compatibility

The versatility of the 2-Port USB-A PCI-Express Card makes it a cost effective solution. The USB 3.1 PCIe is backwards compatible with USB 3.0, USB 2.0, and USB 1.1 so you can stay connected to legacy USB devices and avoid the hassle and high cost of purchasing new peripherals.



Features

- Add two USB Type-A ports to your desktop computer
- USB 3.1 PCIe physical x4 Lane Host Adapter
- Two USB 3.1 Type-A downstream connectors on board
- Supports data transfer speed of up to 10Gbps
- Compliant with USB 3.1 Specification Revision 1.0
- Compliant with PCI Express Specification 3.0
- Each USB port supplies maximum 5V/3A power output

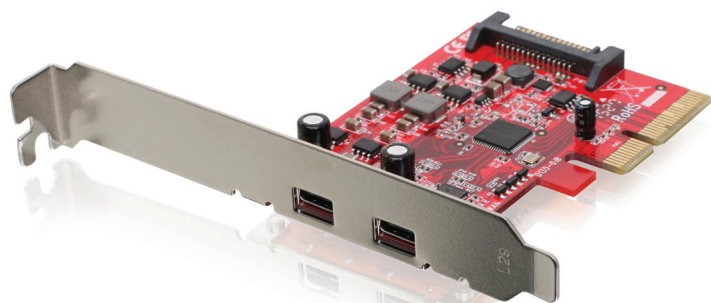

GIC3C2

2-Port SuperSpeed+ USB-C PCI-Express Card

2-Port SuperSpeed+ USB-C PCI-Express Card

IOGEAR's GIC3C2 2-port USB-C PCI Express card adds USB 3.1 (gen2) Type-C ports to your computer. The high performance expansion card includes a low-profile bracket and features efficient construction that fits into any x4, x8 and x16 PCIe slot. This PCIe card instantly upgrades your computer by equipping it with a lightning fast data transfer rate of 10Gbps - that's twice the speed of USB 3.0 (5Gbps) and almost 20 times that of USB 2.0 (480Mbps).

Cost Effective Backwards Compatibility

The versatility of the 2-Port USB-C PCI-Express Card makes it a cost effective solution. The USB 3.1 PCIe card is backwards compatible with USB 3.0, USB 2.0, and USB 1.1 so you can stay connected to legacy USB devices and avoid the hassle and high cost of purchasing new peripherals. It is also compatible with PCI Express 1.1, 2.0, and 3.0 specifications.

Features

- Add two USB Type-C ports to your desktop computer
- USB 3.1 PCIe physical x4 Lane Host Adapter
- Two USB 3.1 Type-C downstream connectors on board
- Supports data transfer speed of up to 10Gbps
- Compliant with USB 3.1 Specification Revision 1.0
- Compliant with PCI Express Specification 3.0
- Each USB port supplies maximum 5V/3A power output

GIC3U2

2-Port SuperSpeed+ USB-A PCI-Express Card

How does it work?

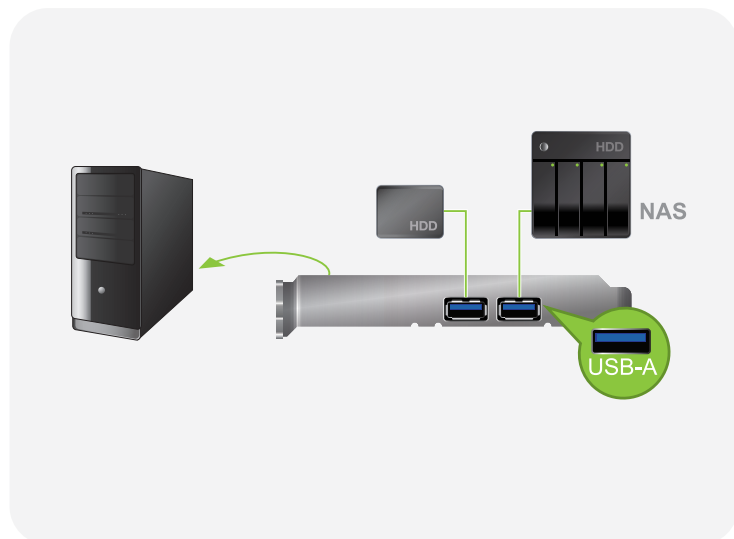

Requirements

Computers

- Windows® 7, Windows® 8, Windows® 8.1, Windows® 10
- Available PCIe x4, x8, or x16 slot

Package Contents:

- 1 x GIC3U2
- 1 x Low-profile bracket
- 1 x Quick Start Guide
- 1 x Warranty Card



GIC3C2

2-Port SuperSpeed+ USB-C PCI-Express Card

How does it work?

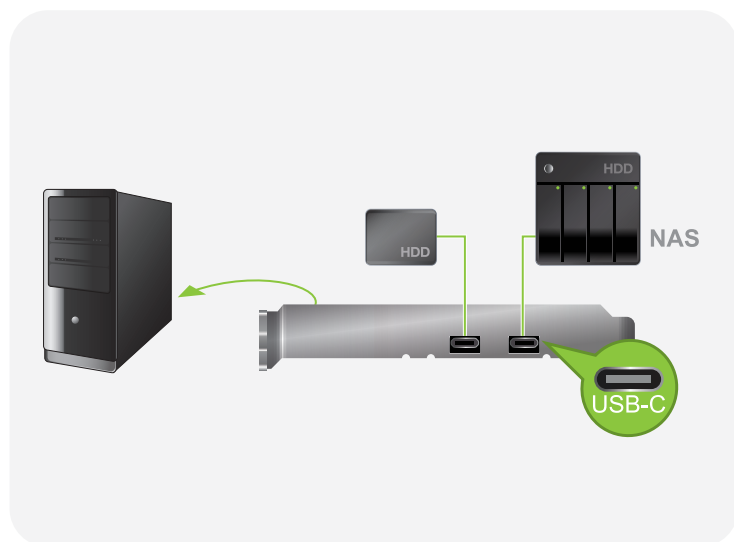

Requirements:

Computers

- Windows® 7, Windows® 8, Windows® 8.1, Windows® 10
- Available PCIe x4, x8, or x16 slot

Package Contents:

- 1 x GIC3C2
- 1 x Low-profile bracket
- 1 x Quick Start Guide
- 1 x Warranty Card

