

GUC2025H

USB 2.0 to HDMI External Video Card



USB to HDMI

The IOGEAR USB 2.0 to HDMI External Video Card instantly enables you to connect a high resolution HDMI display through your USB 2.0 port on your computer. Extend your desktop to watch HD quality videos on your flat panel TV or use it to increase productivity in your office environment with this HDMI video card.

Adding an HDMI display to your computer setup improves your multimedia experience like never before. Watch HD movies on one display, while reading your email on the other. Expand spreadsheets across both monitors or increase your working area in graphics programs by putting all your pallets on the second display.

IOGEAR's USB 2.0 to HDMI External Video Card is powered through the USB cable, so no additional power supply is needed. By using USB, there is no need to open the computer case. Installing a second video card to a desktop or laptop can be complicated and impossible in some cases. With the IOGEAR HD Display Adapter, installation is a breeze. Simply install the CD driver, plug the adapter into the USB 2.0 port and you're ready to go!

- Connect your desktop, laptop, or ultrabook to a large screen TV
- Extend your desktop with multiple monitors
- Enjoy resolutions of up to 1600x1200 / 1920x1080 at 32-bit color
- Support both video and audio signals*
- Bus Powered - No external power supply needed
- No need to open cases- Great for laptops or leasing computers

Office Use:

- View large spreadsheets across two screens with display continuity
- Multitask more effectively without overlapping windows
- Open attachments on one screen while reading the e-mail on the other

*If use more than one USB to HDMI adapter, users can only select one of the display devices for sound output

Graphic Use:

- Use second display for pallets & tools

The possibilities with the IOGEAR USB to HDMI External Video Card are endless:

Home Use:

- Watch stored content or stream online content to your computer and display on your TV

Data Entry Use:

- Type documents on one screen while viewing reference material on the other

Wall Street:

- Use a notebook for viewing multiple screens
- View charts and live data at the same time

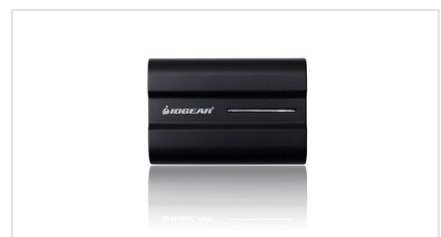

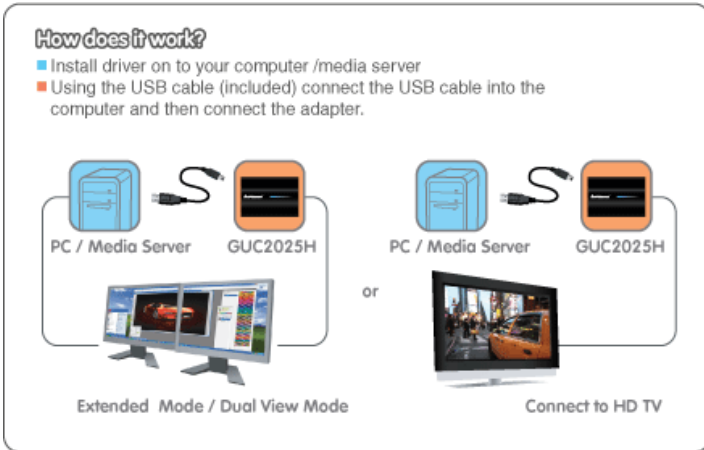

Requirements

Package Contents

- Windows® 10, Windows® 8.1, Windows® 8, Windows® 7, Windows Vista®, Windows XP®
- Intel based Apple computer Mac OS X 10.4+
- Available USB 2.0 port (not compatible with USB 1.x)
- Pentium 1.6 GHz processor (CPU) with 1GB of system memory
- Monitor with HDMI Connector

- 1 x USB 2.0 to HDMI External Video Card
- 1 x CD-ROM with User Guide and Installation Software
- 1 x USB 2.0 Cable
- 1 x Quick Start Guide
- 1 x Warranty Card

Specifications

Function	GUC2025H
Power Consumption	5V
Ports	1 Female HDMI / 1 USB 2.0 Type mini-B
Operating Temperature	68 ~ 122 F (20 ~ 50 C)
Video Resolution	Max 1920 x 1080
Video connections	
Input	USB
Output	HDMI
Humidity	20-80% RH, (Non Condensing)
USB Specification	2.0 compliant
Connectors	
USB	1
Video Output	1
Color Depth	32-bit true color
Power Mode	USB

Dimensions	GUC2025H
POP Information	
10" Peg Hook	7
6" Peg Hook	5
Unit Dimensions	
Width	4.20 in
Height	0.63 in
Length	2.80 in
Inner Pack	
Width	5.50 in.
Height	8.75 in.
Depth	4.00 in.
Inner Pack Qty.	3
Unit Package Dimensions	
Width	5.125 in
Height	9.25 in
Depth	1.15 in
Master Carton	
Width	16.50 in
Height	10.00 in.
Depth	11.50 in.
Master Carton Qty.	24
Weight	
Master Carton Wt.	11.70 lb.
Inner Pack Wt.	1.30 lb.
Unit Pack Wt.	0.36 lbs
Unit Wt. w/accessories	0.25 lb
Unit Wt.	0.16 lb