

GWU627

## Universal Wi-Fi N Adapter - Ethernet to Wi-Fi N



### Wi-Fi Ethernet Adapter

Get your Ethernet enabled devices such as Gaming Consoles, Blu-ray™ players, computers or HDTV connected to your wireless home network.

The new IOGEAR Universal Wireless-N Adapter allows you to connect your device such as a Blu-ray player, HDTV, or game console to any Wireless-N network in your home or office. The Wireless-N (IEEE™ 802.11n) Adapter works with any device with an Ethernet port. No need to purchase an USB adapter that only works with a specific brand or device. After configuring the GWU627, simply connect the adapter to your device without worrying about re-wiring your home.

Using dual antennas (1T1R) this product provides data rates up to 150Mbps and reduces Wi-Fi dead zones in your wireless environment. This new standard supplies sufficient bandwidth for faster file transfer, music downloads, video streaming, on-line gaming & HD multi-media applications. In addition to the increased speed and coverage, you will be pleased to know that it is compatible with your existing 802.11b and 802.11g routers and access points. The unit also features a WPS (Wi-Fi Protected Setup™) button offering a quick and secure network setup.

Avoid long stringing cables and enjoy the freedom to place your home entertainment center anywhere and still be connected to the Internet.

- Add High-Speed 802.11n Internet Access to Any Ethernet Enabled Device Such as a Blu-Ray Player, TIVO, HDTV, Game Console or Media PC
- Compatible Network Standards: IEEE 802.11n (Up to 150Mbps) IEEE 802.11g (Up to 54Mbps) IEEE 802.11b (Up to 11Mbps)
- Avoid long stringing cable and enjoy the freedom to access your Ethernet enabled devices wirelessly
- Push-button Wi-Fi Protected Setup™ (WPS) simplifies secure and easy wireless configuration
- Low power requirements allows the device to be powered by an available USB port on the back of your HDTV display
- Wi-Fi N technology improves effective throughput and range over existing 802.11b/g products
- WEP, TKIP, AES, WPA and WPA2 wireless hardware encryption schemes
- Convenient LED status indicators



**How does it work?**

- Connect device to Ethernet enabled device via RJ-45 cable
  - Wirelessly connect your HDTV, game console, Blu-ray™ and more to your Router\*
- Power the device via an available USB Port or attach to the power adapter

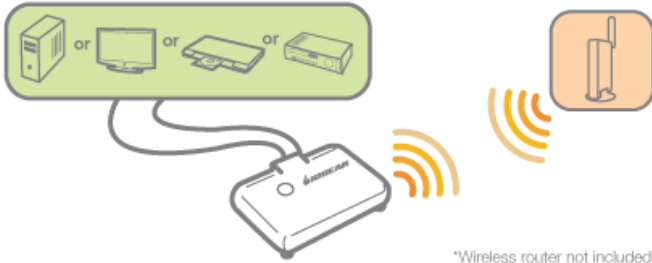

**Requirements**

**Package Contents**

- |  |  |
|--|--|
| <ul style="list-style-type: none"> <li>• Operating System                     <ul style="list-style-type: none"> <li>◦ Windows® 10 , Windows® 8 .1, Windows® 8, Windows® 7, Windows Vista® , Windows XP®</li> <li>◦ Mac OS X v10.4 and above</li> <li>◦ Linux® Fedora 10 (Kernel: 2.6.27.5-117)</li> </ul> </li> <li>• Wireless network with WPS setup</li> <li>• Wireless network without WPS setup and computer</li> </ul> | <ul style="list-style-type: none"> <li>• 1 X Universal Wi-Fi Adapter</li> <li>• 1 X USB Power Cable</li> <li>• 1 X Power Adapter</li> <li>• 1 X Ethernet Cable</li> <li>• 1 X Quick Start Guide</li> <li>• 1 x Warranty / Registration Card</li> </ul> |
|--|--|

## Specifications

Function	GWU627
<b>Power Consumption</b>	Transmit : < 380mA. ; Receive: < 250mA.
<b>Operating Temperature</b>	0 ~ 50 celsius
<b>Storage Temperature</b>	-10 ~ 70 celsius
<b>USB Specification</b>	USB 2.0
<b>Humidity</b>	5 ~ 90% (non-condensing)
<b>Transmission Power</b>	17 dBm
<b>Frequency Band</b>	2.4GHz ~ 2.483GHz unlicensed ISM band
<b>Modulation</b>	IEEE 802.11n: BPSK, QPSK, 16-QAM, 64-QAM
<b>Data Rate</b>	IEEE 802.11n : 6, 9, 12, 18, 24, 36, 48, 54, 60, 90, 120 and up to 150Mbps
<b>Interface</b>	USB 2.0
<b>Security</b>	64-bit or 128-bit WEP/WPA TKIP
<b>Management</b>	Windows-based Utility
<b>Operating Range</b>	100 - 400m, depending on surrounding environment
<b>Encryption</b>	64 bit / 128 bit WEP, TKIP, AES
<b>Antenna Type</b>	On board chip antenna
<b>Range</b>	Up to 320 ft

Dimensions	GWU627
<b>POP Information</b>	
10" Peg Hook	4
6" Peg Hook	3
<b>Unit Dimensions</b>	
Width	2 7/8"
Height	5/8"
Depth	2"
<b>Inner Pack</b>	
Width	14"
Height	7.5"
Depth	9.5"
Inner Pack Qty.	6
<b>Unit Package Dimensions</b>	
Width	6.25"
Height	7.5"
Depth	2.25"
<b>Master Carton</b>	
Width	15"
Height	15"
Depth	10.5"
Master Carton Qty.	12
<b>Weight</b>	
Master Carton Wt.	10.72 lb
Inner Pack Wt.	4.56 lb
Unit Pack Wt.	0.62lb
Unit Wt.	0.08lbs